

VER	DESCRIPTION OF REVISIONS	DATE
A-0		2022/07/01
A-1	Fan change to S17-169, delete S17-142/193-896	2022/07/15
A-2	Mod S16-066/S16-808/S16-836/S22-148	2022/12/26
A-3	Castor change to S19-813	2023/08/15

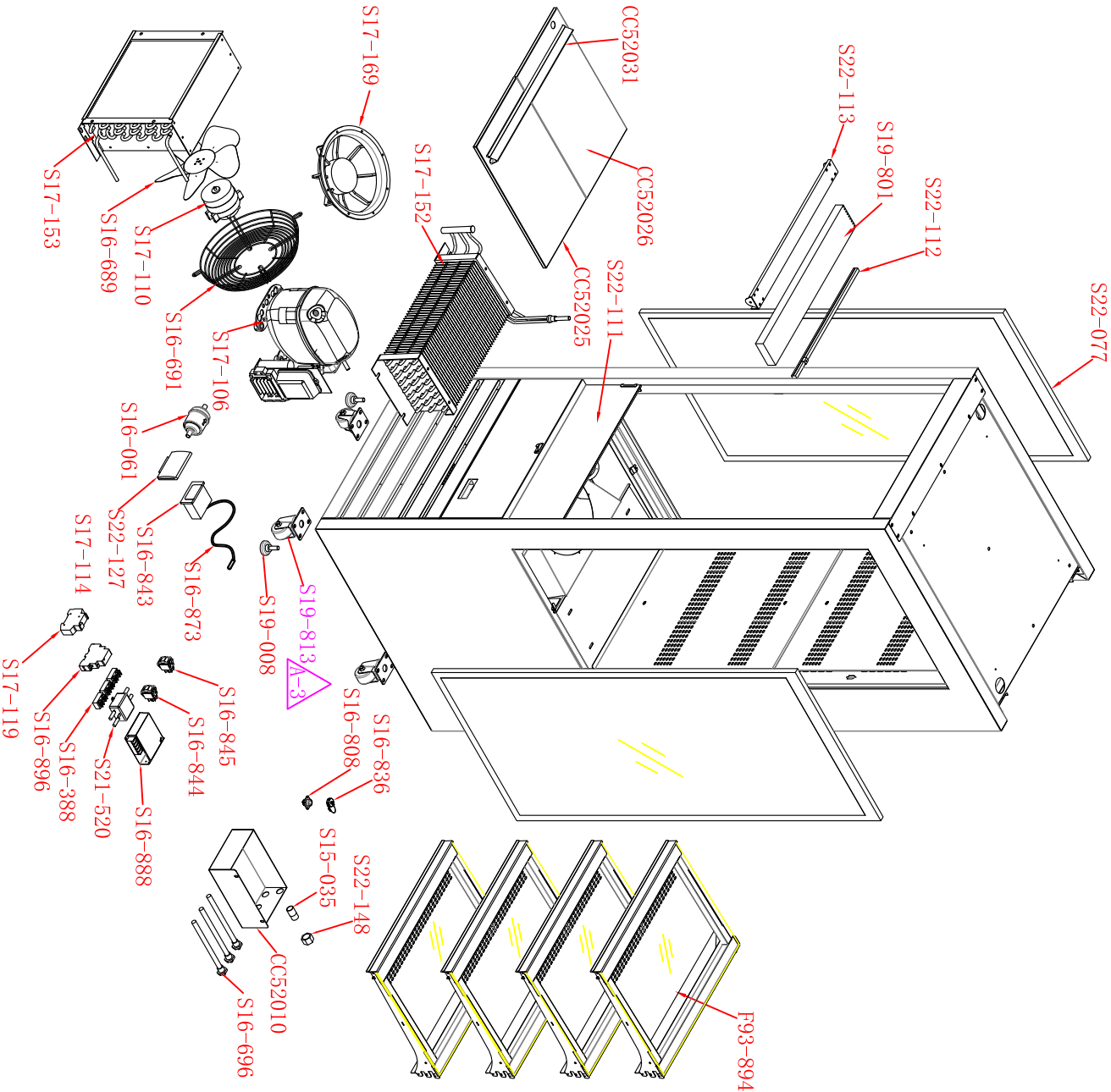

Cossiga F93-218 DTG0R6						
ID	Part No.	Name	Spec	Unit	QTY	Note
1	CC52010	Evaporating pan with heater		PCS	1	
2	CC52025	Deck trays		PCS	1	
3	CC52026	Deck trays		PCS	1	
4	CC52031	Tricket strips of deck		PCS	1	
5	S15-035	Union Coupling		PCS	1	
6	S16-061	Filter	DML-0535-3/8"	PCS	1	
7	S16-388	Terminal block	250VAC, 2.5MM2	PCS	3	
8	S16-689	Fan blade	FY100CW30S50	PCS	1	
9	S16-691	Fan housing of motor	Φ280-80	PCS	1	
10	S16-696	Heater	TCT 1X0 230°240V 25A	PCS	3	
11	S16-808	Socket	WEITLU, WS16K3Z-C, 3P	PCS	4	
12	S16-836	Plastic cap		PCS	4	
13	S16-843	Thermostat	Dixell1, X800CX-5M0C1	PCS	1	
14	S16-844	Power supply button	22A 125/250VAC, Green	PCS	1	
15	S16-845	Lamp button	22A 125/250VAC, Yellow	PCS	1	
16	S16-873	Sensor	Dixell1 M66 3M	PCS	2	
17	S16-888	Power supply	LRS-75-12, 12V/6A	PCS	1	
18	S16-896	Circuit breaker	230/240V	PCS	1	
19	S17-106	Compressor	SECOF, SCE21MMX/R290	PCS	1	
20	S17-169	Fan	ECM HBS 30-25-2, 230V/50/60Hz	PCS	1	
21	S17-110	Fan motor	SSC2B17CHHE2M2 (250V)	PCS	1	
22	S17-119	Fuse wire	RT18-32/1P, 10A/500V	PCS	1	
23	S17-152	Evaporator	650X137X209, Φ7	PCS	1	
24	S17-153	Condenser	288X288X127, Φ7	PCS	1	
25	S19-008	Plastic Footing	M10*55	PCS	2	
26	S19-801	Honeycomb Wind deflector		PCS	1	
27	S21-520	EMI Filter	HT170-10-18-B3	PCS	1	
28	S22-077	Side glass		PCS	2	
29	S22-111	Front PC board		PCS	1	
30	S22-112	LED light	L=1000	PCS	5	
31	S22-113	Night blind		PCS	1	
32	S22-127	Thermostat cap		PCS	1	
33	S19-813	Castor	ST-44W-263	PCS	4	
34	S22-148	Chock plug		PCS	1	
35	F93-894	Shelf assy		PCS	4	